



# Friends of the Melton Botanic Garden, Inc. Newsletter May / June 2013

Growing Plants Growing People

No.26

## **FMBG celebrating 10 years during 2013**



*Eremophila MBG - June 2013 ©Photo Anne Langmaid*

### May Events

**FMBG May Meeting:** Wednesday 8<sup>th</sup> 7.30pm.  
**APS Plant Sale:** Saturday 18<sup>th</sup> Australian Plant Society - FMBG Stall - at Bacchus Marsh from 9am  
**Grow the Garden Day:** Sunday 24<sup>th</sup> 10am-noon meet at the Melton Botanic Garden Depot

### June Events

**Clean Up Day:** Sunday 9<sup>th</sup> 10am-noon. Meet at MBG Depot (William Street).  
**FMBG June Meeting:** Wednesday 12<sup>th</sup> 7.30pm  
 Guest Speaker Liz Bennetto – Wathaurong people and plants for food, medicine, tools, weapons, containers and more.  
**FMBG Social Dinner:** Friday 21<sup>st</sup> 6.30pm  
**Grow the Garden Day:** Sunday 23<sup>rd</sup> 10am-noon meet at the Melton Botanic Garden Depot  
**Bird Watching:** Sunday 30<sup>th</sup> 9am with Daryl Akers

### Regular Activity Groups

\***Gumnuts:** 1<sup>st</sup> & 3<sup>rd</sup> Tuesday 10am-noon Eucalyptus Arboretum  
 \***Lakers:** 2nd & 4th Tuesday 10am-noon – Meet at the Lake  
 \***Creekers:** Thursdays 9am-noon – Meet Depot/Ryans Creek



Winner 2011 Powercor Melton Business Excellence Awards  
**"Leaders in Sustainability 2011"**



Winner 2012 Powercor Shire of Melton Business Excellence Awards  
**"Best Community or Not for Profit Organisation 2102"**

**Wednesday 12<sup>th</sup> June 7.30pm**

**Liz Bennetto**

**Wathaurong people and plants for food, medicine, tools, weapons, containers and more.**

**Note venue for June only:  
 Blackwood Drive Hall (former Guide Hall), Blackwood Drive (off Thomas Ave), Melton South**

For information contact Janet Dyke: 9743 2733

### FMBG Monthly Meeting Venue (Mar-Nov)

Monthly meetings are usually held at the DJ Cunningham Centre in Exford Rd, Melton South (Melways 342 K3) at 7.30pm on the second Wednesday night of each month.

There is parking, easy access, a good meeting space, kitchen and toilets.

*For the JUNE meeting only due to renovations at the DJ Cunningham Centre we will hold the meeting at the Blackwood Drive Hall (Former Guide Hall), Blackwood Drive (off Thomas Ave), Melton South.*

### Executive Committee

The Executive Committee Meetings are held monthly on the 3<sup>rd</sup> Tuesday 7.30pm at the Bentley's house

*Editor's note – some items in the newsletter are a bit out of date. The newsletter was started a while ago but due to being overseas and illness it was only finished on 12 June. Thanks to everyone who contributed to this newsletter. Hoping the next issue comes out on time.*



**FMBG Patron**  
**Jane Edmanson OAM**

**2013**

## **10<sup>th</sup> Anniversary of FMBG**

FMBG turns 10 this year.

Look how we have grown and what we have achieved.

September is the 10<sup>th</sup> Anniversary of holding the first Public Forum to consider forming a friends group and developing a botanic garden in Melton.

On September 15 we will have an Open Day, Beth Gott is a special guest speaker on the use of Australian Plants by Aboriginals at the FMBG meeting on 10 September and we will have a 10<sup>th</sup> Anniversary Dinner on Friday 27 September to celebrate the occasion.

If you would like to help in the planning for the open day celebration and events throughout the year please let John or Jill know.

## **Lake Embankment Plantings**



Have you been down to Lake Embankment recently to see the growth in the indigenous plants that were planted last year? It is amazing how well many grown.

## **July 1 is Getting Closer! Time to Renew Your Membership**



We had 206 members on 30 June 2012

We are aiming to at least maintain this target for 2012/2013

Current membership is just over 180

New members joining after 30 April will hold their membership until 30 June 2014

**Please ensure you have renewed and try to sign up a friend**

For membership information please contact: Jill Bentley 9743 3819 or see the website

## **Wanted! A Nursery Manager**



The new FMBG Plant Nursery is taking shape. Many thanks to David Pye and Dave Peters and many others who have been helping with construction of the shade house and benches.

Would you like to take on the role of Nursery Manager or recommend someone? This is a voluntary position and we are preparing a draft business plan. We plan to grow plants for the garden but hope to retail section to help raise funds.

Some storage sheds are being constructed thanks to an MCC grant and the SP AusNet cheques awarded to FMBG for Tony Dyke's work in the MBG. We are purchasing propagation pots at a much reduced price.

## **FMBG on 3AW**

Did you get to hear FMBG on Jane and Darren's The Big Backyard on 25<sup>th</sup> May? If you missed it have a look at <http://www.3aw.com.au/gardening>

## FMBG March Social Dinner



At the FMBG social dinner on 24<sup>th</sup> March Jill Bentley won the Easter Basket raffle prize which was kindly donated by Don Nardella MLA.



There is another social dinner on Friday 21 June at 6.30pm at the Golden Fleece Hotel on High Street. Why not join us for a meal and to have good catch up with everyone.

## Plants of Melbourne's Western Plains 2<sup>nd</sup> Ed.

FMBG copies to sell of this excellent book which was released in August 2012.

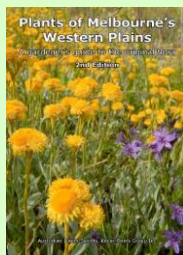

This book is available to purchase from Margaret Peters on 5367 3328

**\$15 members, \$20 non-members**

It is an excellent resource for members and you might like to purchase it as a present for someone.

## Bird Walk Sunday 30<sup>th</sup> June

Daryl Akers will be leading the Melton Bird Walk on Sunday 30<sup>th</sup> June at the MBG starting at 9am from the Depot and finishing about 11am. Over time over 55 bird species are been recorded in the Melton Botanic Garden.

Black swans at the Lake



Photo courtesy Nora Peters

Australian Raven in the MBG



Photo courtesy Anne Langmaid

Crested pigeon in the MBG



Photo courtesy Anne Langmaid

Purple swap hen at the MBG



Photo courtesy Anne Langmaid

### Call for tools

Do you have any useable tools that you can donate to FMBG?



We are seeking tools such as saws, hammers, screwdrivers, pliers, adjustable wrenches, spanners, spirit levels, tape measures etc. and even power tools (but only if they are in a good, safe and working condition).

Please contact John Bentley if you have any tools that you can donate – 9743 3819

### Queen Scout Awarded

Rachel Bentley completed the requirements for the Queen Scout Award and chose to have the presentation ceremony at the Melton Botanic Garden.

FMBG congratulates Rachel on receiving this very distinguished award.

Rachel is an FMBG member. She did her Environmental badge for Scouts through FMBG activities. Rachel has placed a Geocache somewhere in the MBG for people to find. This has attracted a number of visitors who would not normally know about the Melton Botanic Garden.

It is very encouraging and good news that she selected the MBG for her presentation.

Rachel receiving her award



Photo courtesy Colleen Thompson

### Eucalyptus petiolaris

Keep look out for the labels David and Barb Pye donated and installed in the Eucalyptus Arboretum.

Donated label



Photo courtesy John Bentley

Eucalyptus petiolaris is a small to medium-sized tree endemic to South Australia where it is found on southern Eyre Peninsula, mainly in the Koppio Hills, and further north around Cleve, Darke Peak and Caralue, usually in valleys or on flat country near water. The bark is rough and loosely flaky near the base or wholly smooth and the adult leaves are slightly glossy, green to dark green. The flowers are sometimes reddish. It has been recorded as flowering in in August, September, October, November and January. Well the ones in the Eucalyptus Arboretum south-west section are flowering now as shown in the photo below.

E. petiolaris was originally recognised as a subspecies of E. leucoxylon because of the petiolate seedling and juvenile leaves, and later raised to species rank. The four subspecies of E. leucoxylon all have the early seedling and juvenile leaves sessile.

Source: *Euclid* 3.0

Eucalyptus petiolaris



Photo courtesy John Bentley

### Eucalyptus Arboretum Contacts

Project Manager: David Pye (5428 9369) dabpye@gmail.com  
 Working Party Chair: John Bentley (9743 3819) president@fmbg.org.au  
 Plants: Barb Pye (5428 9369) dabpye@gmail.com  
 Site Preparation: David Pye (5428 9369) dabpye@gmail.com  
 John Bentley (9743 3819) president@fmbg.org.au  
 Funding: John Bentley (9743 3819) president@fmbg.org.au

### Queen's Birthday Awards

Congratulations to Lynette Holdsworth and Leo Johnson on being awarded the Medal of the Order of Australia (OAM). Both have been members of FMBG from the beginning and have served terms on the executive committee. Leo has been the FMBG Public Officer until just recently.

### Vale Ted Whitehead



Ted Whitehead passed away on Monday 3 June shortly after being diagnosed with cancer. Ted had been a member for many years and was actively involved in planting and weeding. Everyone will remember him for his Cornish Miners Pick. Photo of Ted digging in June 2012.

### Eucalyptus Arboretum

The understory is looking good. See the Sticky Everlasting (*Xerochrysum viscosum*) below in the east section and the purple Swainsona galegifolia in the south western section.



Photo: Anne Langmaid



Photo: Anne Langmaid

From Les and Elaine

### Monthly Meeting - 8 May 2013

Although our guest speaker was not in attendance, it was very capably filled in by Barb Pye. Her talk was on Small Gardens with emphasis on Going Potty. I don't mean insanity but Australian growing plants in pots. All sorts, shapes and sizes of pots. If you don't have a large garden area this was the way to go. It was very interesting and I think everyone got some ideas for their own home.

Also she showed us Wilsons Promontory. How things have changed since her and Dave were there last.

Alan told us the trip to Cherry Lake Altona and the visit to Williamstown Botanical Gardens went down well. Everyone enjoyed themselves.

Bus trip members



Photo: John Bentley

On 18th May we have the APS Plant Sale in Bacchus Marsh. Volunteers are needed in helping either to erect the stands or dismantle the stands.

Also we are awaiting the judge's decision for KABV Award. John showed a tremendous presentation to the judges of all our work and hopefully we can win this award.

Margaret and Dave are overseas enjoying a well-earned holiday. Other members will be on holiday soon. This leaves the rest of us to fill their shoes.

### Gumnuts and Creekers

Weeding and watering are our two main concerns at the moment. Water from above would not go astray. A lot of thanks go to David Pye and John Candy on their days for supplying their 4 wheel SUVs to tow the water carrier. Without their help we would be in diabolical trouble.



Gumnuts

Also many thanks go to CVGT for their assistance in maintaining and watering the plants, trees and shrubs. Also to the PAG group (people with disability) who help out every month. Also before I forget, thanks to the students from the University Campus for their help in constructing the information shelter. Every little bit helps. Thanks.

## Melton Botanic Garden

Layout Plan

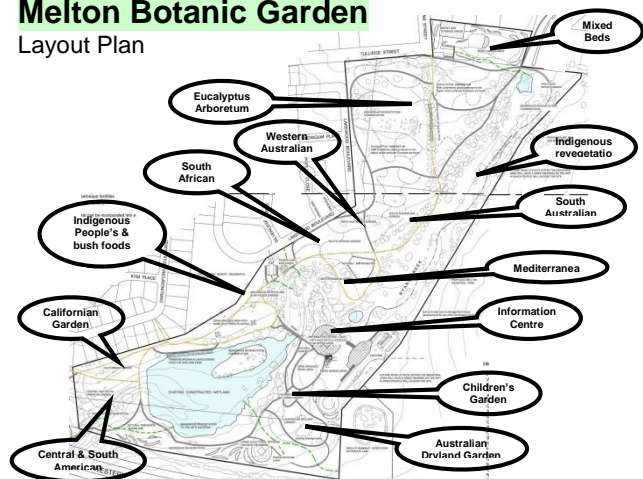

## Membership

Have you renewed your membership or encouraged others to join FMBG?

FMBG is local, regional and international. We have members in Switzerland, China, Hong Kong, New Zealand, UK, USA, and Saudi Arabia. Please encourage some new memberships from your contacts. We reached 148 members in 2009-2010, 141 members for 2010-2011. We had 206 members in 2011-2012. So please try to sign up a new member to help us keep a strong membership base.

Single-\$10, Single concession or student-\$5, Household/Concession-\$20/\$10, Associate-\$20, Corporate-\$50

The Membership/Renewal form is available on the FMBG website.

You can also pay by direct bank transfer to FMBG.

**Account Name:** Friends of the Melton Botanic Garden Inc.

**BSB:** 033-121 **Account Number:** 20-8503

**Please ensure that your name appears under the transaction details. In addition, also submit the form or email to [friends@fmbg.org.au](mailto:friends@fmbg.org.au)**

New memberships are approved each month at the Executive meeting.

Please call Jill 9743 3819 for information or to drop in a payment. If you are housebound we can arrange to collect your payment and form.

## 2013 Calendar

The calendar is available. We have confirmed nearly all the speakers for meetings and trips for 2013. **What suggestions do you have for 2014 activities? Please let us know.**

## Facebook Fans

If you use Facebook you may want to keep up with information via the Friends of the Melton Botanic Garden Group. Type "Melton Botanic Garden" into the Facebook search box and you should be able to find the group.

## FMBG Corporate Members 2011/12

### Melton Home Timber and Hardware

45 Reserve Road, Melton, VIC 3337  
Ph: (03) 9743 5033  
Manager: Ken Morton

### Melton Produce

38-42 Brooklyn Road, Melton South, Vic. 3338  
Ph: (03) 9743 5201  
Manager: Peter Earl

### Melton Toyota

143-147 High Street, Melton, Vic, 3337  
Ph: (03) 8746 0300

### Platinum Accounting & Taxation

9 Sheepfold Court, Melton Vic 3337  
Ph: (03) 9746 6479  
Manager: Corinne Cole  
Email: [info@platinumaccounting.com.au](mailto:info@platinumaccounting.com.au)

### Satellite City Furniture

358 High Street Melton, VIC, 3337  
Ph: 03 9743 4749 or 9743 6205

### SOV Consulting

Melton VIC 3337  
Ph: (03) 9746 7558  
Manager: Con Nikakis Email: [nikakisc@gmail.com](mailto:nikakisc@gmail.com)

### Western Land Services

20 Collins Road, Melton, VIC 3337  
Ph: (03) 9747 0855 Fax: (03) 9747 9593  
<http://www.westernland.com.au>

## Your Executive Committee

President:	John Bentley (9743 3819)
Vice-President:	Alan Partridge (9743 5761)
Treasurer:	Margaret Peters (5367 3328)
Secretary:	Janet Dyke (9743 2733)
Assistant Secretary:	Alan Partridge (9743 5761)
Executive members:	Jill Bentley (9743 3819)
	Dave Peters
	Corinne Cole
	Myles Bentley
Safety Officer:	John Bentley
FMBG librarian:	Jean Partridge (9743 5761)

**FMBG can give presentations to groups as well**

### Newsletter:

Editor: John Bentley (9743 3819)  
Email: [editor@fmbg.org.au](mailto:editor@fmbg.org.au)

**as host guided tours of the garden**



If you have stories or photographs from activities in the Melton Botanic Garden please send them to: [editor@fmbg.org.au](mailto:editor@fmbg.org.au)

oooOOooo